

Riverflow® Pool Grate by Current Systems Inc.

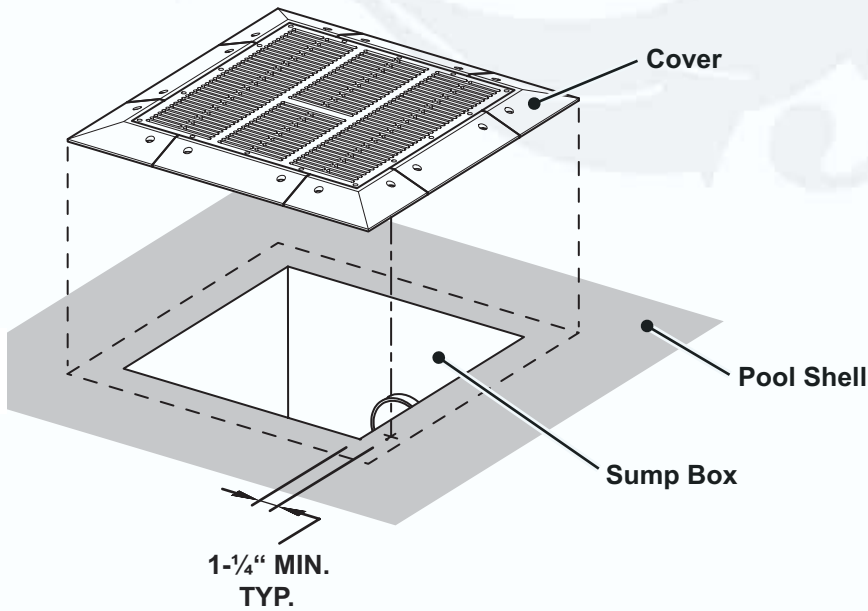

Step 1.

Center the frame assembly over the sump box area.

Anchor holes must be 1-1/4" minimum away from edge of sump.

Mark hole locations onto pool shell using frame anchor holes.

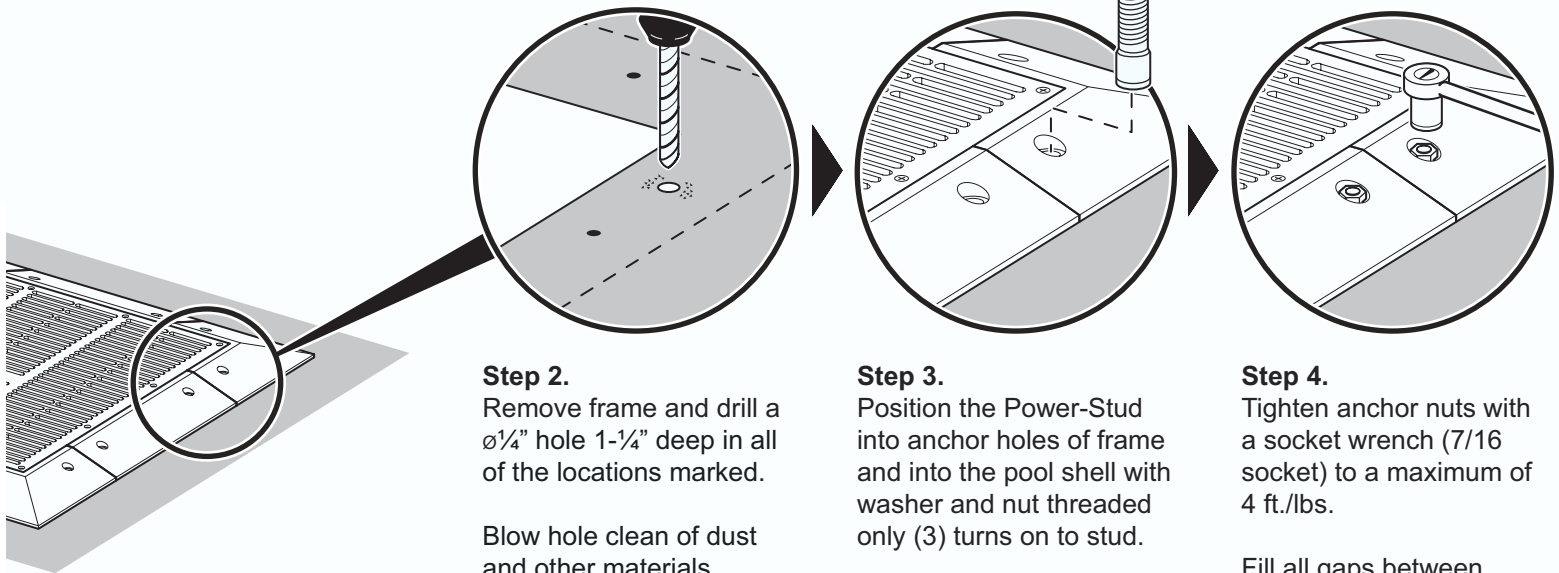

Step 2.

Remove frame and drill a $\varnothing 1/4$ " hole 1-1/4" deep in all of the locations marked.

Blow hole clean of dust and other materials.

Reposition frame back over holes.

Step 3.

Position the Power-Stud into anchor holes of frame and into the pool shell with washer and nut threaded only (3) turns on to stud.

Drive the anchor into the pool shell until the washer and nut are firmly seated into the bottom of the counterbore.

Step 4.

Tighten anchor nuts with a socket wrench (7/16 socket) to a maximum of 4 ft./lbs.

Fill all gaps between frame and pool surface with an approved patching material and inspect annually. Inspect frame, grate and hardware annually. Replace cracked or oxidized parts Immediately.