

# 6" ROUND HOCKEY PUCK SUMPLESS SUCTION OUTLET COVER, HYDROAIR/ITT REPLACEMENT



**VGBA CERTIFIED SPECIFICATIONS**

**Open Area**  
10.4 in<sup>2</sup>

For SOFA Specific Flow Ratings and specifications please scan QR code or visit [www.aquastarpoolproducts.com/flowcode](http://www.aquastarpoolproducts.com/flowcode)



## FEATURES

Certified, Listed, and Labeled in conformance with APSP/ANSI/ICC-16 2017 and NSF/ANSI/CAN 50 standards

See next page for eight adapter plates sold separately, available for sumpless connections to 1022s, 1½" female adapters, 1½" and 2" inside and outside slip and threads

Easily and safely retrofits many HydroAir/ITT parts

Manufactured from superior UV-resistant engineered polymers

#316 stainless steel screws

Trademarked VGBA compliance button easily identifies VGBA 2017 compliant cover from on deck and underwater

Online product support including downloadable CAD files, General Certificate of Conformity, third-party certificate, installation instructions and more

Replace drain cover every five years from the date of installation

25 per case

## No sump required!



Part # 6HPHAXxx

### STANDARD COLORS

- 6HPHA101 – White
- 6HPHA102 – Black
- 6HPHA103 – Light Gray
- 6HPHA105 – Dark Gray
- 6HPHA108 – Tan

Replaces p/n 6HPxxx and 4HPxxx\*  
\*Use p/n 4HPAPKxxx for 4HPxxx replacement or replace 4" bulkhead with a 6" bulkhead

**VGBA 2017 Compliant**

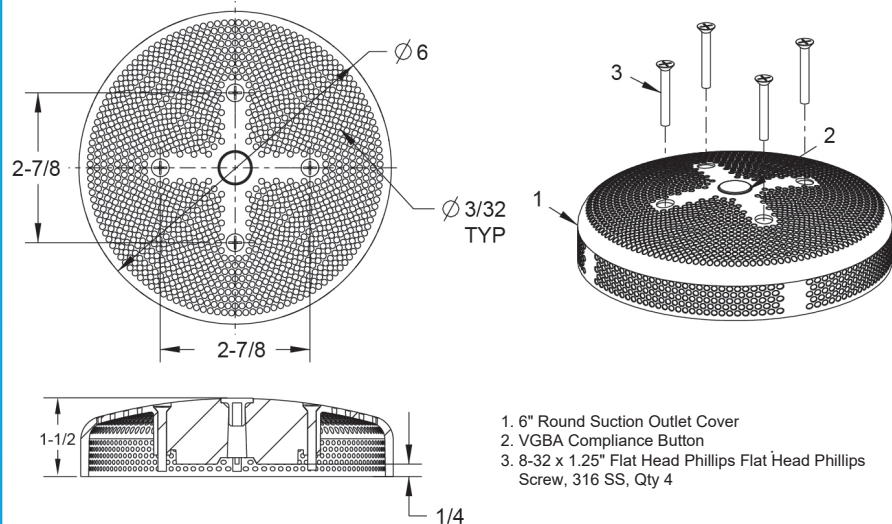

1. 6" Round Suction Outlet Cover
2. VGBA Compliance Button
3. 8-32 x 1.25" Flat Head Phillips Flat Head Phillips Screw, 316 SS, Qty 4

**ADDITIONAL PRODUCT CONFIGURATIONS FOR 6HPHxxx (sold separately) 25/case**

STANDARD COLORS     101   102   103   105   108

**Code Key:**   xxx = Color (i.e. 101 = White)   15 = 1 1/2", 20 = 2"   25 = 2 1/2"   SI = Slip Insider   T = Thread

**6" Bulkhead Adapter for 4HPxxx Replacement**

For 4HPxxx replacements

**NEW**



Part #  
4HPAPxxx

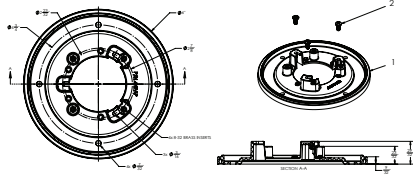

- 1. 4" Round Hockey Puck Adapter Plate
- 2. 8-32 x 3/8" LG. Pan Head Phillips 316 SS, Qty 3



Optional - Extra screw holes for anchoring directly into pool finish using four brass anchor kit part # BIK4

**6" Bulkhead Adapter with 2 1/2" Thread and 2" Socket for Fiberglass/Steel, with Gasket and 2 1/2" Locking Nut**



Part #  
6HA25T20Sxxx

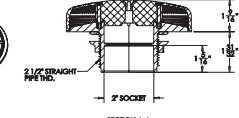
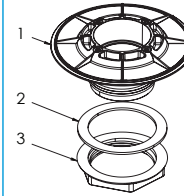

- 1. 6" Bulkhead Adapter With 2-1/2" Thd. x 2" Soc. Sumpless Fitting
- 2. Gasket, 2-1/2" Thd.
- 3. Nut, 2-1/2" Straight Pipe Thd.

**6" Bulkhead Adapter with 1 1/2" Threaded Sumpless Fitting**

Fits 1022 female adapters



Part #  
615Txxx

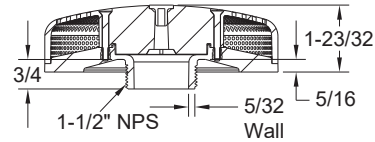

- 1. 6" Sumpless Bulkhead With 1-1/2" NPS

**6" Bulkhead Adapter with Extended 1 1/2" Threaded Sumpless Fitting**

Use with flush mount 1 1/2" FPT, does not fit 1022 female adapters



Part #  
6E15Txxx

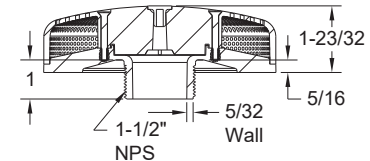

- 1. 6" Sumpless Bulkhead With Extended 1-1/2" NPS

**6" Bulkhead Adapter with 1 1/2" Slip-Insider Sumpless Fitting**



Part #  
615Slxxx

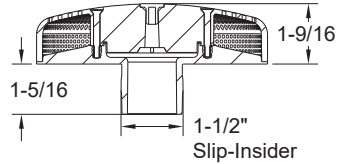

- 1. 6" Sumpless Bulkhead With 1-1/2" Slip-Insider

**6" Bulkhead Adapter with 2" Slip-Insider Sumpless Fitting**

Also available as 1 1/2" slip-insider p/n 615Slxxx



Part #  
620Slxxx

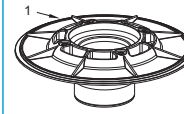
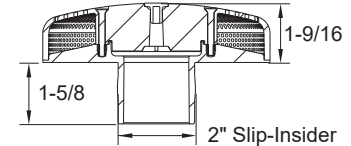

- 1. 6" Sumpless Bulkhead With 2" Slip-Insider

**6" Bulkhead Adapter with 2" Socket Sumpless Fitting**



Part #  
RNDxxx

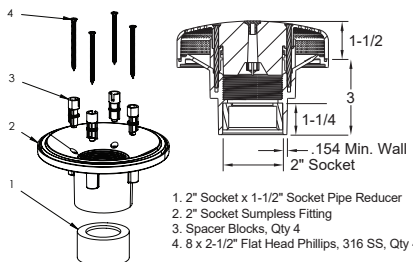

**6" Bulkhead Adapter with 2" Threaded x 1 1/2" Socket Sumpless Fitting**



Part #  
620T15Sxxx

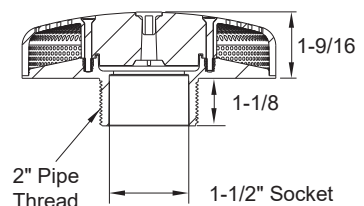

- 1. 6" Sumpless Bulkhead With 2. 2" Thread And 1-1/2" Socket